



Integrative Design:

Community Engagement as a Participatory Design Process

13th Annual “New Partners for Smart Growth Conference”
Building Safe, Healthy, Equitable and Prosperous Communities

Denver, Colorado February 13-15, 2014,

Abode Communities:

Founded in **1968** as a volunteer organization of architects, Abode Communities has provided comprehensive architectural services and technical assistance to more than 500 community groups on projects including permanent, sustainable affordable housing, homeless shelters, child care centers, health clinics and senior centers.



Our Mission:

At Abode Communities our mission is to open new doors in people's lives through creative and responsible design, development and operation of service-enhanced affordable housing.



What is a Community Design Process?

abode

Community Meetings vs. Community Design Process

Community Meetings :

A gathering of a designated part of the community to discuss a certain topic to either build support or counter skepticism about a given topic.

Or a gathering in which, regardless of the reason for its convening, someone stands up to complain about something.



Community Meetings vs. Community Design Process

Community Design Process:

Is not a series of community meetings, it is a design approach that attempts to actively involve all stakeholders in the process, to create environments that are more responsive and appropriate to their inhabitants' and users' cultural, emotional, spiritual and practical needs.



“Design” Process:

The rules have to be clear, the community won't design the final project but has to be engaged at multiple stages to help define the problem and to focus ideas for solution as well as to help evaluate proposed solutions.

the team has to be willing to abandon their preconceived notion of what the “right” thing to do is.

If we're there to just sell an idea, the audience will know, so be prepared for solutions coming out of left field and giving them a chance.



Be Honest:

Clearly outline what the challenges are. The Community is willing to compromise, but needs to understand both the costs and benefits of these decisions



Parking Question:
If there are fewer parking spots what are the repercussions in the built environment? what will the neighborhood look like? what other benefits we will see?



Identifying Priorities:

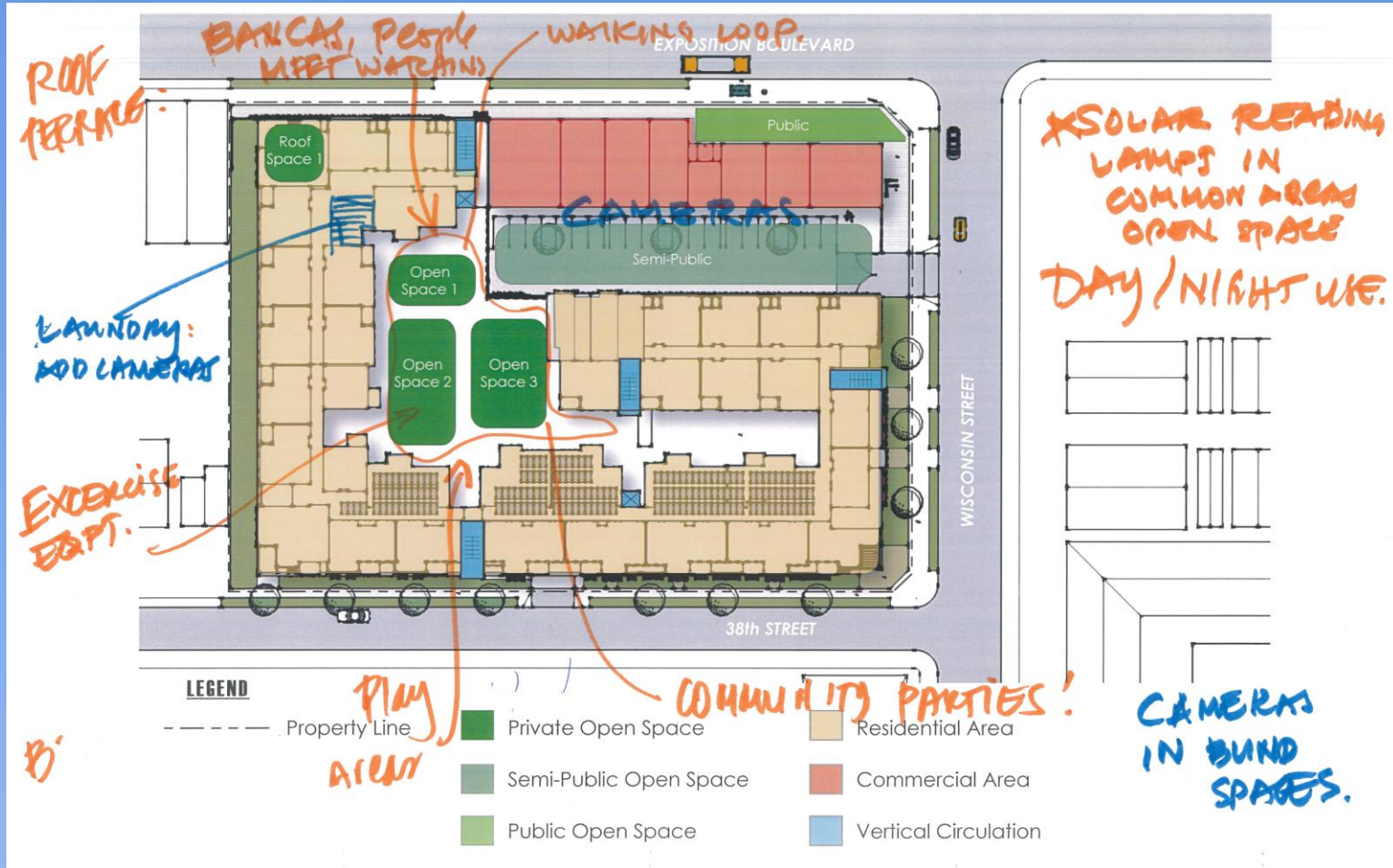

“Design” Process:

Preliminary solution:

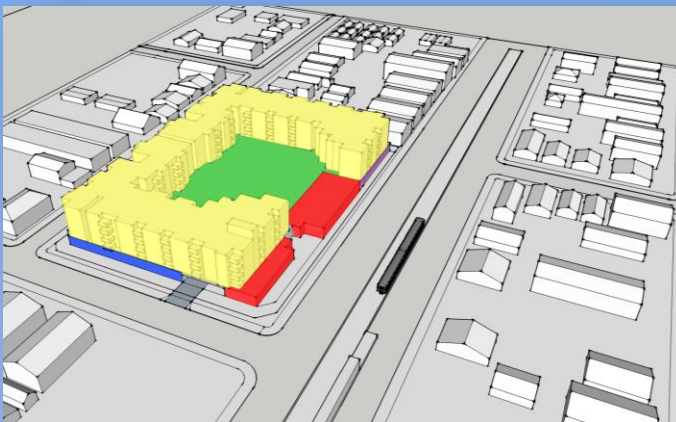
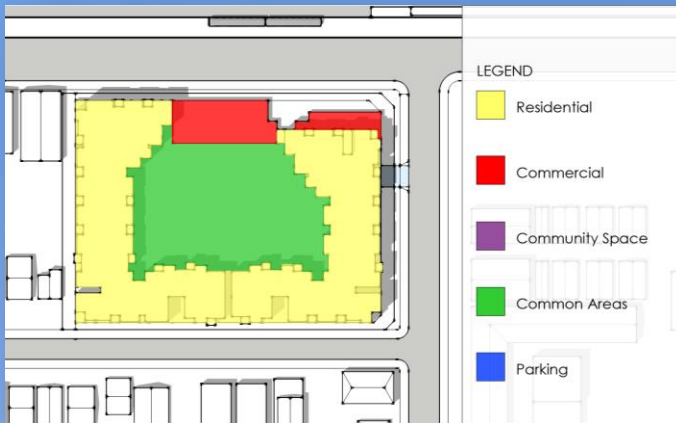

Integrated Design Solution:



Conclusion:

This is not a short or easy process but a very enriching one were the design process achieves a political dimension of user empowerment and democratization, turning future neighbors into advocates, a great force of support as the project moves forward...



Results

Development Details

abode

Development Details:



Development Details:



Rolland Curtis Gardens:



- Transit Oriented Development
- Amenities for residents
 1. Community Gardens
 2. Landscaped Courtyards
 3. Tot-lot
 4. Community Meeting Space
 5. Free internet & computer lab
 6. On-site Laundry on each floor
 7. “Beyond Homes” Resident Services Program

- 140 affordable rental homes
- LEED for Homes Certified
- 8,000 square feet of commercial space
- 132 spaces of parking (114 residential/ 18 commercial)
- On-site Resident Property Management Office & Manager





- Rene Rodriguez, rrodriguez@abodecommunities.org
Associate, Abode Communities, Architecture